

DAMMON
ENGINEERING, INC.

EMMETT
DAMMON

ARCHITECT
ROBERT
WILTSE

1095 FLORIDA AVENUE
SLIDELL, LA. 70458
985-649-5832

WEBSITE:
WWW.DAMMONENGINEERING.COM
EMAIL:
DAMMONEN@BELLSOUTH.NET

ARCHITECTURE
ENGINEERING
STUDIES
PLANNING
INVESTIGATION
EXPERT WITNESS

CENTURY PARK
UNIVERSITY OF
SOUTHERN
MISSISSIPPI

IDN-ACME INC.
1504 JUSTIN RD.
METAIRIE, LA 70001

NP1 & NP3
CAMERA LOCATION
& CABLE LAYOUT

REV: #1 10/30/09

SCALE: AS NOTED
JOB#: 2028

DATE: 6-29-2009

SHEET: 7

SEC 2-1

OF: 8

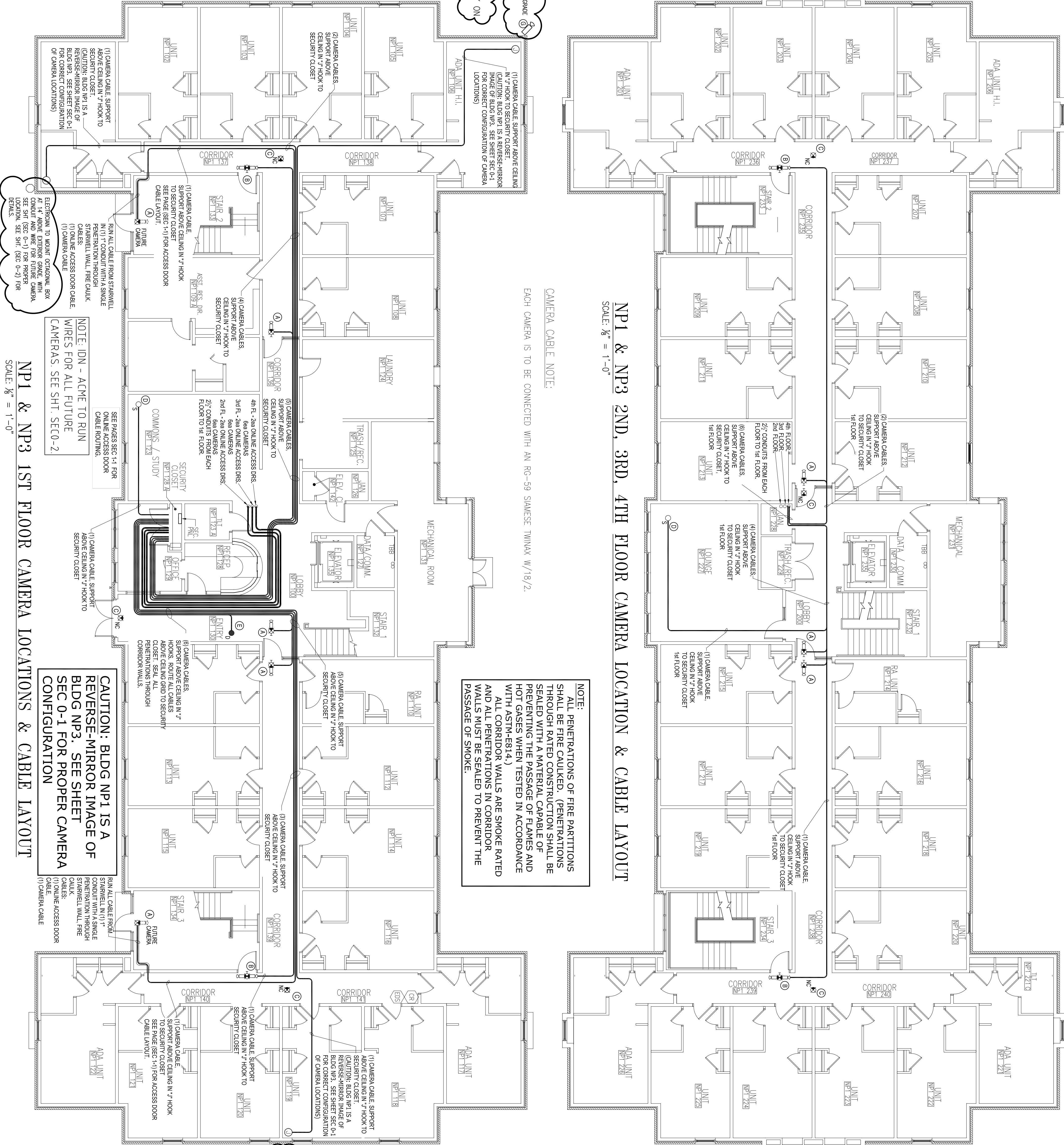

- LEGEND**
- (A) - WEDEX EXIT SIGN W/COVERT CAMERAS
MODEL - WDE-600C (SINGLE)
 - (B) - WEDEX EXIT SIGN W/COVERT CAMERAS
MODEL - WDE-600C (DOUBLE)
 - (C) - E-COULIGHT LED EXIT SIGN/BATTERY BACKUP
SINGLE/DOUBLE FACE MODEL E-XPRBW WITH/OUT
CAMERA
 - (D) - ARM ELECTRONICS SMOKE DETECTOR CAMERA
MODEL - CS20SDCS
 - (E) - COSTAR SUPER HIGH RESOLUTION MINI
DOME CAMERA
 - (F) - COSTAR MINI PTZ HIGH SPEED DOME CAMERA
MODEL - CDC2500MXO
 - (G) - IR MAX ALL-IN-ONE ENVIROCAM
MODEL - OBC3510IR

NOTE:
SEE DWG. SEC 0-2 FOR
CAMERA DETAILS.

NOTE:
SEE DWG. SEC 0-1
FOR EXTERIOR
CAMERA LOCATIONS.

GENERAL NOTES:

- CORE DRILL HOLES FOR 2½" CONDUIT IN JANITORIAL CLOSET,
3 EA IN 2nd FLOOR, 2 EA IN 3rd FLOOR AND 1 EACH IN 4th
FLOOR (SEE DETAIL ON SEC 0-2).
- INSTALL 1-2½" SLEEVE ABOVE DOOR IN JANITORIAL CLOSET
AND CAULK TO PREVENT THE PASSAGE OF FIRE & SMOKE
(TYPICAL 2nd, 3rd & 4th FLOORS). AFTER INSTALLATION OF ALL
SECURITY CAMERA AND ACCESS DOOR CABLES SLEEVE IS TO
BE FILLED WITH A MATERIAL TO PREVENT THE PASSAGE OF
FIRE AND SMOKE.

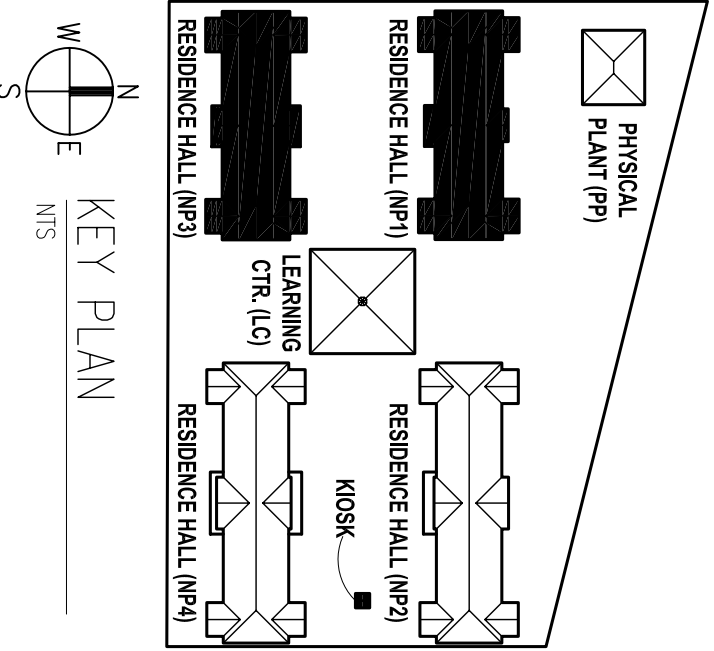

NP1 & NP3 2ND, 3RD, 4TH FLOOR CAMERA LOCATION & CABLE LAYOUT

SCALE: ¾" = 1'-0"

CAMERA CABLE NOTE:

EACH CAMERA IS TO BE CONNECTED WITH AN RG-59 SAMESEX TWINAX W/18/2.

NOTE:
ALL PENETRATIONS OF FIRE PARTITIONS
SHALL BE FIRE CAULKED. (PENETRATIONS
THROUGH RATED CONSTRUCTION SHALL BE
SEALED WITH A MATERIAL CAPABLE OF
PREVENTING THE PASSAGE OF FLAMES AND
HOT GASES WHEN TESTED IN ACCORDANCE
WITH ASTM-E814.)
ALL CORRIDOR WALLS ARE SMOKE RATED
AND ALL PENETRATIONS IN CORRIDOR
WALLS MUST BE SEALED TO PREVENT THE
PASSAGE OF SMOKE.

NP1 & NP3 1ST FLOOR CAMERA LOCATIONS & CABLE LAYOUT

SCALE: ¾" = 1'-0"

